

Hypertherm®

MAX200

Machine torch parts

MAX200 consumables



MAX200



128380 - Standard body - 2" sleeve



128365 - Stainless steel body

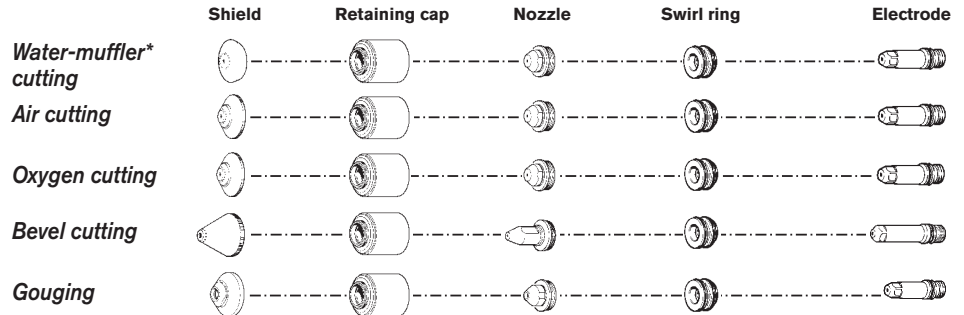

APPLICATION	PLASMA GAS	CONSUMABLE DESCRIPTION	PART NUMBER				QUANTITY PER PACKAGE	
			200 AMP BEVEL	200 AMPS	100 AMPS	40 AMPS		
CUTTING	Oxygen	Electrode-Standard	120258	220021	120547	-----	5	
		Electrode-SilverPlus	-----	220083	-----	-----	5	
		Swirl ring	120833	020604	020617	-----	1	
		Nozzle	120259	020605	020616	-----	5	
		Retaining cap	020423	020423	020423	-----	1	
		Retaining cap, ohmic	120837	120837	120837	-----	1	
		Shield	120260	020424	020448	-----	1	
		(Water muffler*)	Shield	-----	020566	020618	-----	1
		Air	Electrode	-----	220021	120547	120667	5
			Swirl ring	-----	020607	020607	020613	1
	Nozzle		-----	020608	020611	020689	5	
	Retaining cap		-----	020423	020423	020423	1	
	Retaining cap, ohmic		-----	120837	120837	120837	1	
	Shield		-----	020424	020448	020688	1	
	(Water muffler*)		Shield	-----	020566	020618	-----	1
	Argon/Hydrogen	Electrode	-----	020415	020415	-----	5	
		Swirl ring	-----	020607	020607	-----	1	
		Nozzle	-----	020608	020611	-----	5	
		Retaining cap	-----	020423	020423	-----	1	
		Retaining cap, ohmic	-----	120837	120837	-----	1	
Shield		-----	020602	020448	-----	1		
Nitrogen		Electrode	-----	020415	-----	-----	5	
	Swirl ring	-----	020607	-----	-----	1		
	Nozzle	-----	020608	-----	-----	5		
	Retaining cap	-----	020423	-----	-----	1		
	Retaining cap, ohmic	-----	120837	-----	-----	1		
	Shield	-----	020424	-----	-----	1		
	(Water muffler*)	Shield	-----	020566	-----	-----	1	
GOUGING	Air	Electrode	-----	220021	-----	-----	5	
		Swirl ring	-----	020607	-----	-----	1	
		Nozzle	-----	020615	-----	-----	5	
		Retaining cap	-----	020423	-----	-----	1	
		Shield	-----	020485	-----	-----	1	
	Argon/Hydrogen	Electrode	-----	020415	-----	-----	5	
		Swirl ring	-----	020607	-----	-----	1	
		Nozzle	-----	020615	-----	-----	5	
		Retaining cap	-----	020423	-----	-----	1	
		Shield	-----	020485	-----	-----	1	

* Water muffler cannot be used with 2" 120356 stainless steel torch or with ohmic height sensing.

MAX200 machine torch assembly

128380 – Standard body – 2" sleeve
 128364 – Optional body – 1¾" sleeve

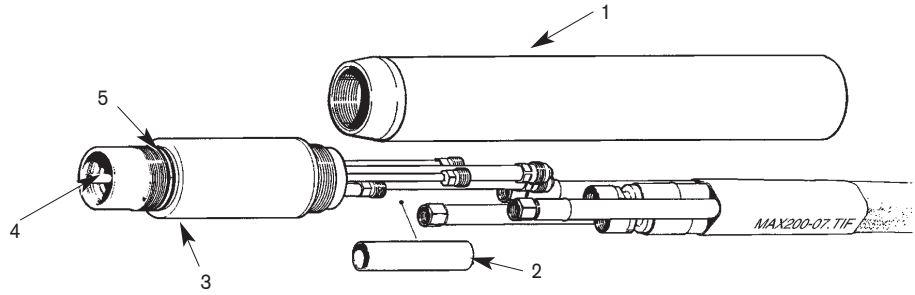

ITEM NUMBER	STANDARD BODY (2") PART NO.	DESCRIPTION	OPTIONAL BODY (1¾") PART NO.
	128380*	MAX200 machine torch assembly	128364
	028383**	Leads, torch, 25' / 7.6 m	028383
	028384**	Leads, torch, 50' / 15.2 m	028384
1	120894	Torch mounting sleeve	020431
2	020536	Lead insulator, 9/16 x 2.5"	020536
3	120584	MAX200/HT2000 machine torch main body	120584
4	020963	Water tube, electrode cooling, standard	020963
4	120257	Water tube, electrode cooling, extended	120257
5	044027	O-ring: Buna 70 Duro 1.301 x .070	044027^



128380 – Standard body – 2" sleeve

* Assembly includes consumables

** Other lead lengths available.
 Consult your Operating Manual.

128365 – Stainless steel body

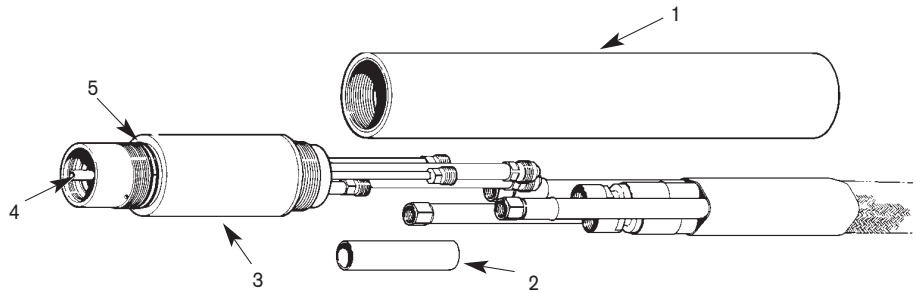

ITEM NUMBER	PART NO.	DESCRIPTION
	128365*	MAX200 machine torch assembly
	120356	MAX200/HT2000 machine torch main body
	028384**	Leads, torch, 50' / 15.2 m
1	020041	Torch mounting sleeve
2	020536	Lead insulator, 9/16 x 2.5"
3	028383**	Leads, torch, 25' / 7.6 m
4	020963	Water tube, electrode cooling, standard
4	120257	Water tube, electrode cooling, extended
5	044027	O-ring: Buna 70 Duro 1.301 x .070



128365 – Stainless steel body

* Assembly includes consumables

** Other lead lengths available.
 Consult your Operating Manual.